

# Site Accommodation

[www.atcosl.com.au](http://www.atcosl.com.au)



Site Offices | Complexes | Lunchrooms | Toilets | Ablutions | Change Rooms | First Aid Rooms

**ATCO Structures & Logistics**



# Contents

Business Profile	2
Offices	3
Lunchrooms	5
Change Rooms / First Aid	5
Toilets	6
Locations	7

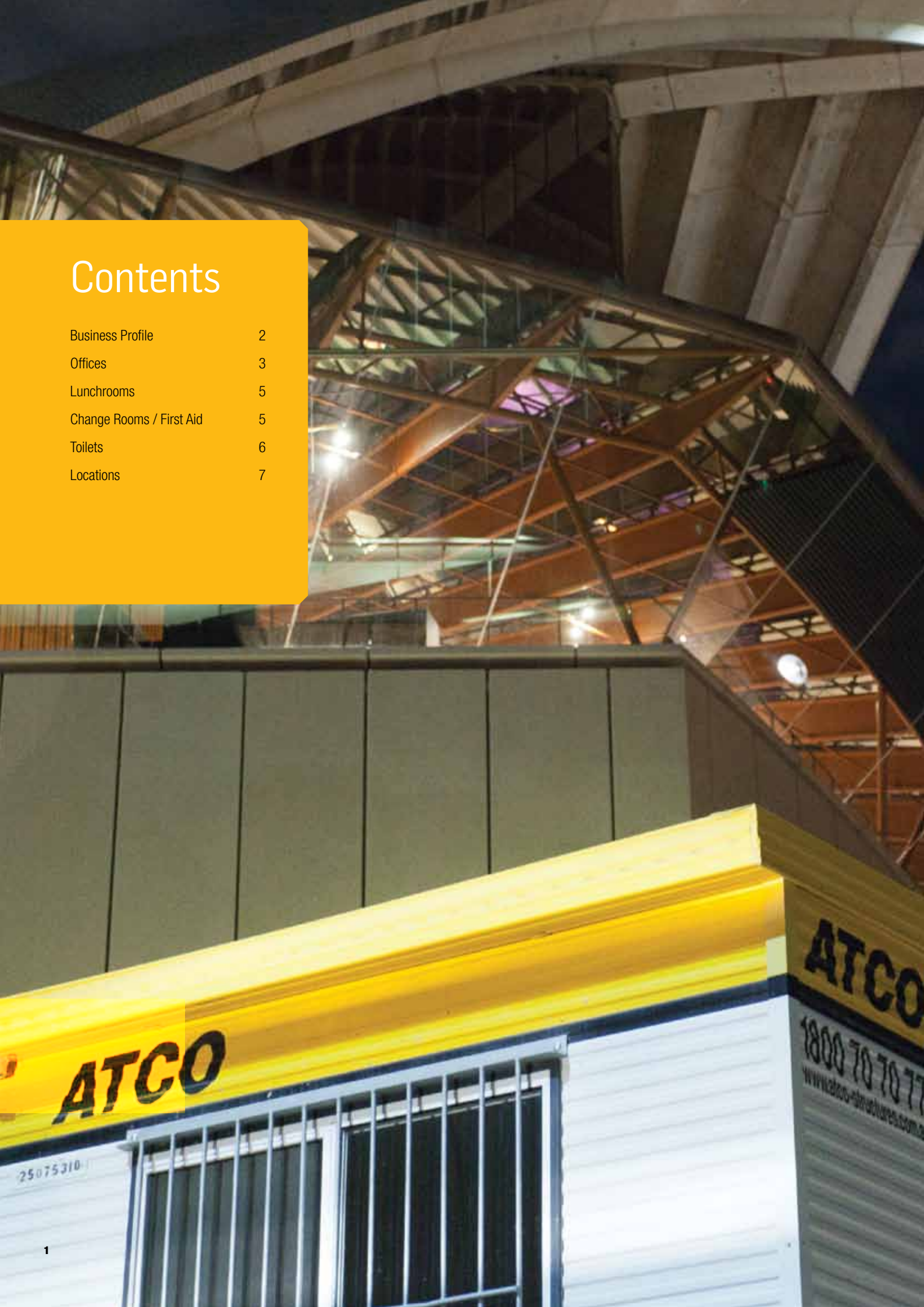

# Business Profile

ATCO Structures & Logistics (ATCO) is recognised as one of Australia's leading modular building providers.

With a history that dates back to 1947, **ATCO** has a reputation of delivering modular solutions and associated site services on time and on budget. **ATCO** has been associated with numerous projects that have been milestones in shaping Australia's industrial history. **ATCO** has developed into an internationally recognised brand that has operations within North America, South America, Middle East, Asia and Europe.

**ATCO** has a primary focus within Australia and has developed a network of offices and infrastructure in Townsville, Mackay, Gladstone, Brisbane, Newcastle, Sydney, Melbourne and Perth to meet the ever changing construction and mining industry landscapes presented.

Having built one of Australia's largest rental fleets of modular buildings, **ATCO** are capable of mobilising project needs quickly. **ATCO**'s strength lies in their experience and ability to deliver when it counts. **ATCO** prides itself on providing Australian made products that are built to stand up to the demands of the rigorous environments encountered in remote Australia.

Defining our business through superior service, **ATCO** has retained and developed its workforce who are focused on delivering a multitude of project disciplines, whilst maintaining the core business ethics of professionalism and transparency.

**ATCO** has a diverse customer base and has expertise in delivering products to the construction, mining, education, oil and gas and commercial industries, with the ability to customise building design to suit a specific project requirement. **ATCO** has the expertise and capacity to deliver a rapid, full turnkey solution anywhere, anytime it is needed.

---

"Their adherence to safe processes and site requirements, combined with brilliant work ethics and pride in workmanship is a rare thing to find. I have no hesitation in recommending ATCO to anyone who requires this service."

Shell Refining (Australia) Pty Ltd

---



**ALWAYS THERE. ANYWHERE.**

# Offices

3.0m x 3.0m Office  
OF 100

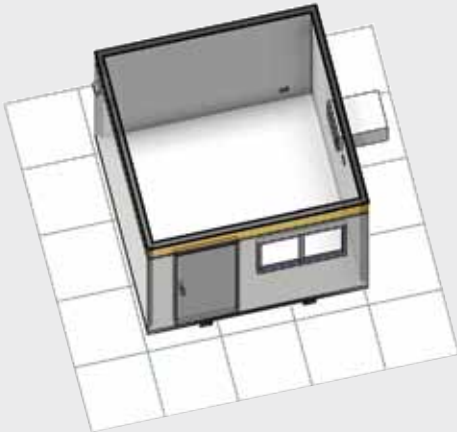

3.6m x 3.0m Office  
OF 110

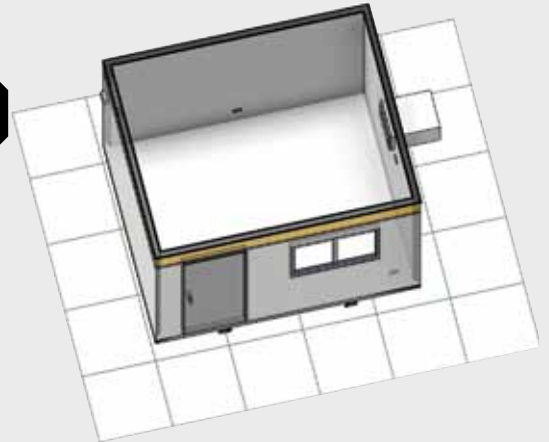

4.8m x 2.4m Office  
OF 115

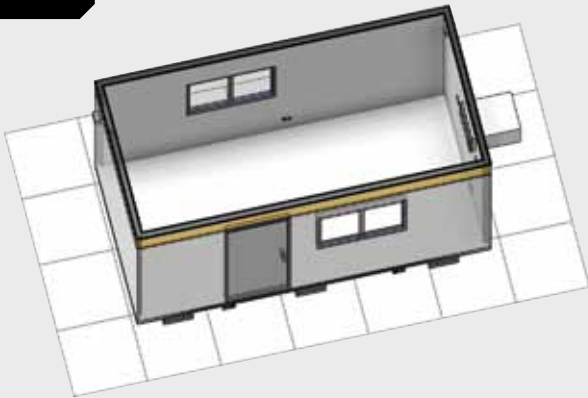

6.0m x 3.0m Office  
OF 130

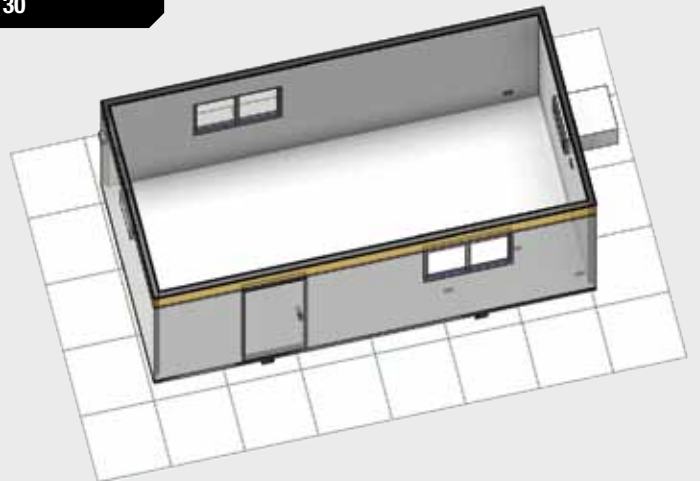

7.2m x 3.0m Office  
OF 140

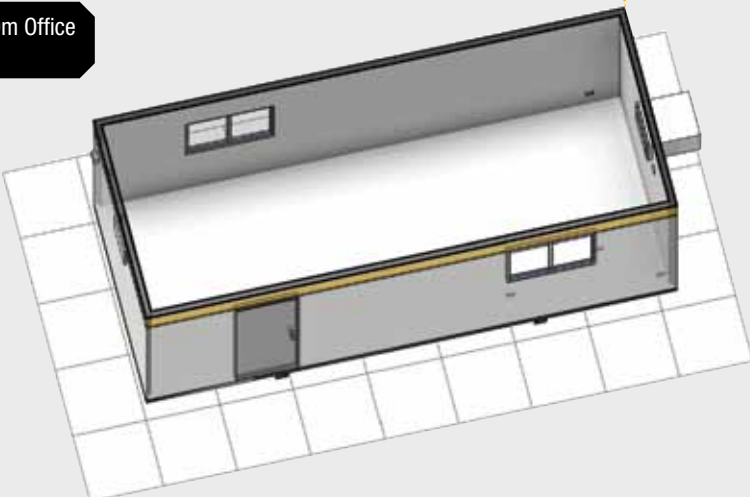

**ALWAYS THERE. ANYWHERE.**

12.0m x 3.0m Office  
OF 190

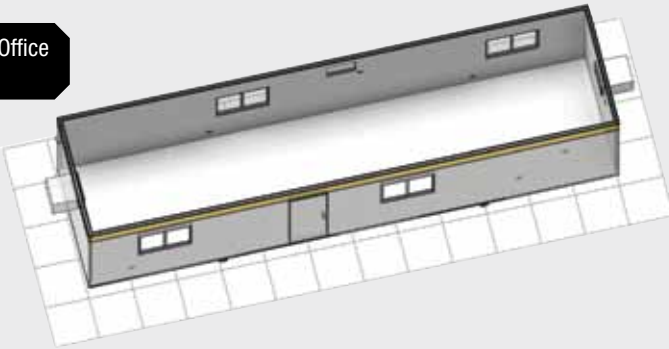

12.0m x 3.0m Office  
OF 191

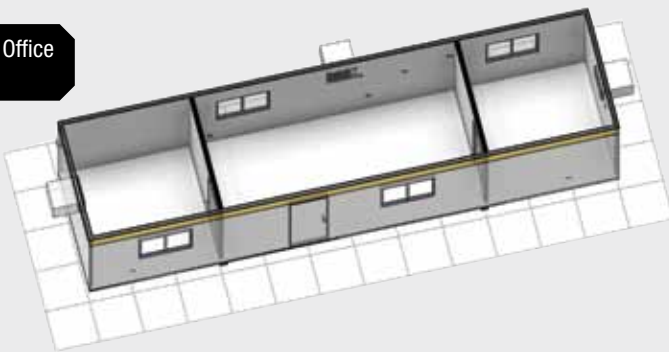

12.0m x 6.0m Office  
OF 510

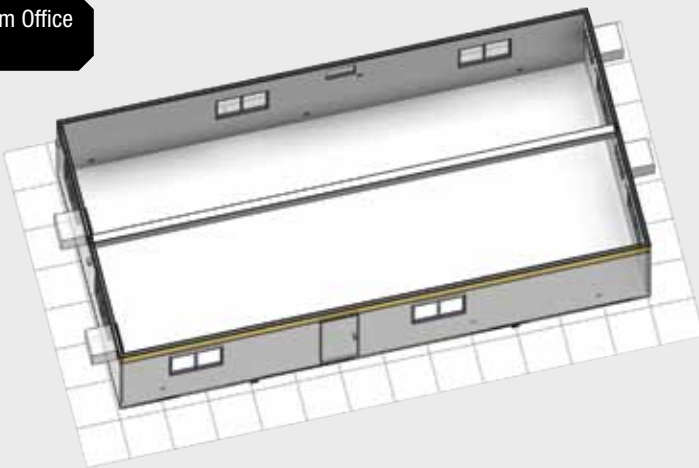

12.0m x 9.0m Office  
OF 525



12.0m x 9.0m Office  
OF 520

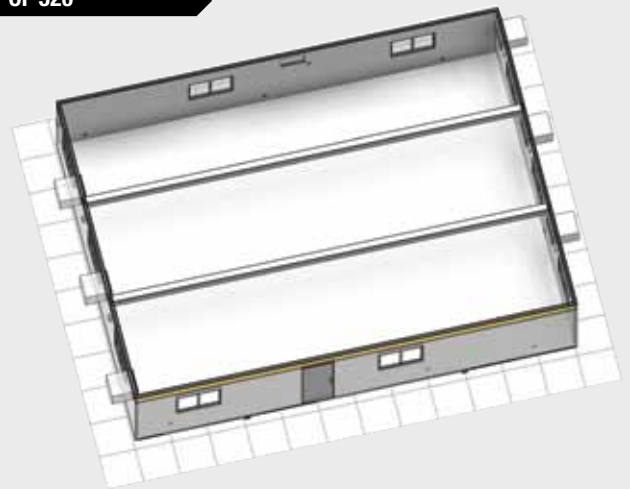

"I have been associated and dealing with ATCO Representatives from the start of 2003 up to the present day and within my relationship with ATCO staff we have achieved many projects such as installations of classrooms, sourcing office solutions and relocating buildings. These works have been carried out to an excellent standard and efficiently always finishing the tasks on time. I have no hesitation in recommending ATCO Structures Staff and the work they do to any prospective company wishing to contract them." Westside Christian College

# Lunchrooms

# Change Rooms / First Aid

4.8m x 2.4m Lunchroom  
LR 010



4.8m x 3m Lunchroom  
LR 012

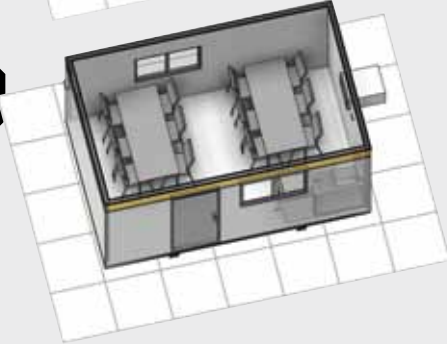

6.0m x 3.0m Lunchroom  
LR 018

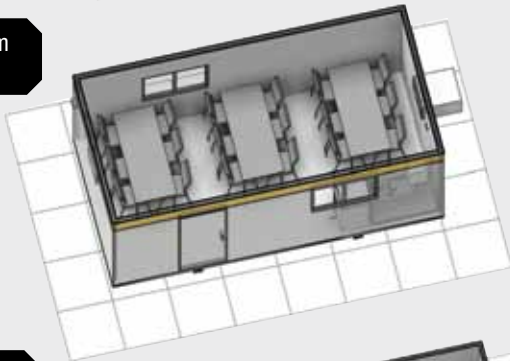

12.0m x 3.0m Lunchroom  
LR 036



6.0m x 3.0m Change Room  
CH 020

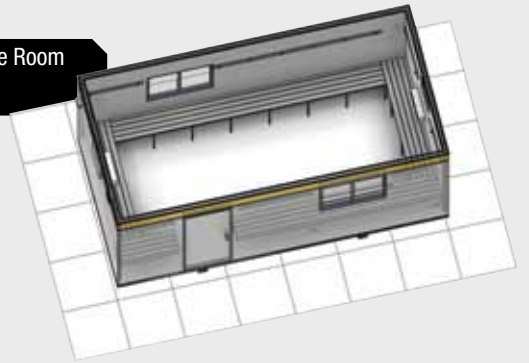

6.0m x 3.0m First Aid  
FA 025

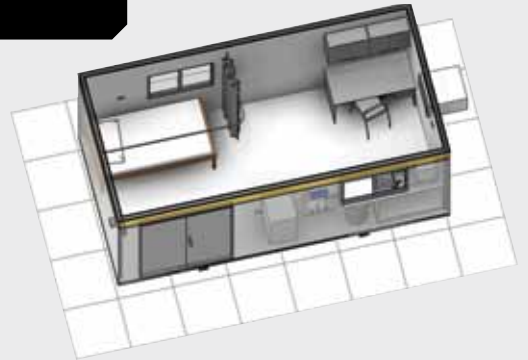

12.0m x 3.0m Change Room  
CH 030



**ALWAYS THERE. ANYWHERE.**

# Toilets

2.4m x 2.4m Male/  
Female Toilet **MFT 010**

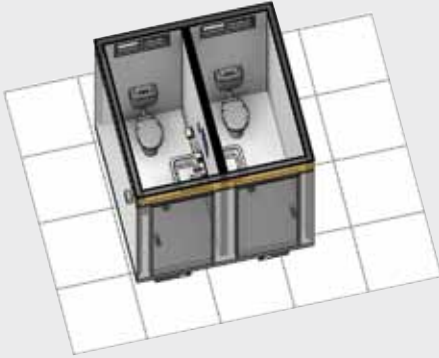

3.0m x 3.0m Toilet  
**WC 015**

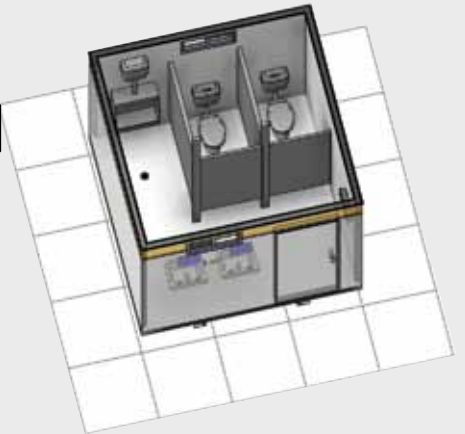

3.6m x 3.0m Toilet  
**WC 020**

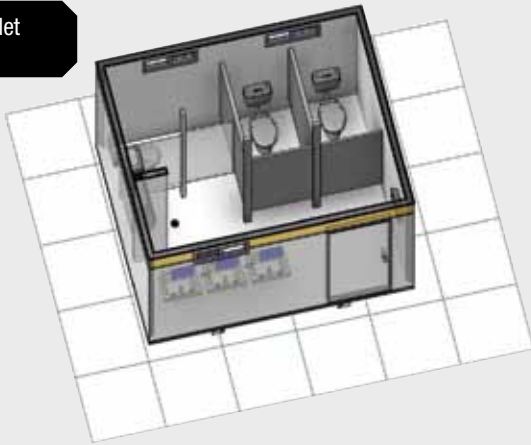

4.8m x 3.0m Male/  
Female Toilet **MFT 015**

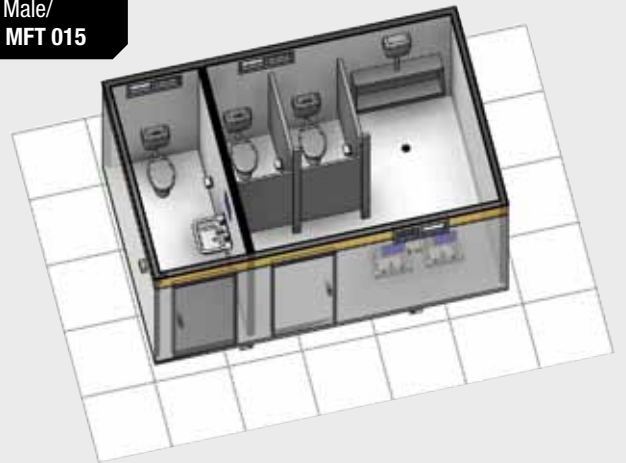

6.0m x 3.0m Ablution  
**AB 040**



4.8m x 3.0m Ablution  
**AB 035**

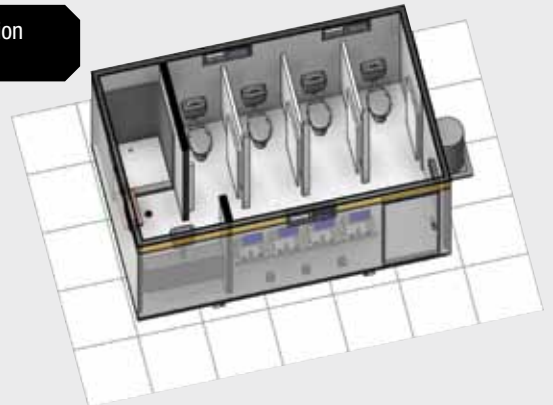

6.0m x 2.4m Tank

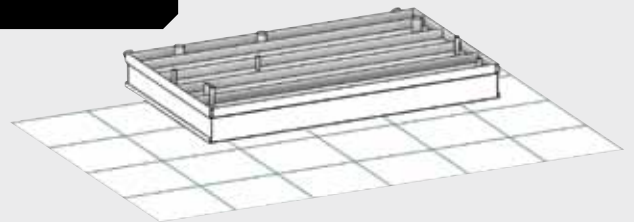

"ATCO were able to meet an extremely tight timeframe imposed by Melbourne Water for the delivery of the project offices and have positively responded to any requests by Melbourne Water to attend to site for minor issues. The site accommodation has been well received and the project was completed in a safe and efficient manner. I have no hesitation in recommending ATCO for any large or small project you may be considering them for." Melbourne Water

# Locations

## QUEENSLAND

### Brisbane

(Australia Head Office)  
ATCO Structures & Logistics Pty Ltd  
149-151 Magnesium Drive  
Crestmead QLD 4132  
Phone: (61) 7 3412 8600  
Fax: (61) 7 3803 6590

### Brisbane

ATCO Structures & Logistics Pty Ltd  
64 Woolshed Road  
Stapylton QLD 4207  
Phone: (61) 7 3382 6299  
Fax: (61) 7 3382 6288

### Townsville

ATCO Structures & Logistics Pty Ltd  
826 Ingham Road  
Bohle QLD 4818  
Phone: (61) 7 4774 6633  
Fax: (61) 7 4774 6440

### Mackay

ATCO Structures & Logistics Pty Ltd  
Walker Complex, Harbour Road  
Mackay QLD 4740  
Phone: (61) 7 4829 3800  
Fax: (61) 7 4942 4469

### Gladstone

ATCO Structures & Logistics Pty Ltd  
11 Ganley Street  
Gladstone QLD 4680  
Phone: (61) 7 4979 0633  
Fax: (61) 7 4979 0655

## NEW SOUTH WALES

### Newcastle

ATCO Structures & Logistics Pty Ltd  
2376 Pacific Highway  
Heatherbrae NSW 2324  
Phone: (61) 2 4987 7340  
Fax: (61) 2 4987 6360

### Sydney

ATCO Structures & Logistics Pty Ltd  
47 Mulgrave Road  
Mulgrave NSW 2756  
Phone: (61) 2 4545 2900  
Fax: (61) 2 4577 7372

## VICTORIA

### Melbourne

ATCO Structures & Logistics Pty Ltd  
128 Hallam Valley Rd  
Dandenong South VIC 3175  
Phone: (61) 3 8765 8200  
Fax: (61) 3 9791 9271

## WESTERN AUSTRALIA

### Perth

ATCO Structures & Logistics Pty Ltd  
28 Armstrong Road  
Hope Valley WA 6165  
Phone: (61) 8 6252 6200  
Fax: (61) 8 6252 6299



**ATCO** Structures & Logistics

### For further information

Telephone – (61) 7 3412 8600

Facsimile – (61) 7 3803 6590

[www.atcosl.com.au](http://www.atcosl.com.au)

